



RVINN

1050 Mary's Lake Rd.
Estes Park, CO 80517
Larimer County
(970) 586-2889



E-mail address: info@sprucelakerv.com
www.sprucelakerv.com
www.facebook.com/navspruce

RV INN Management and staff appreciate the patronage of all our valued customers.

Please visit us at our other locations:

Dakota Ridge RV Resort - Golden, CO 303-279-1625

Elk Meadow Lodge & RV Resort - Estes Park, CO 970-586-5342

After Hours Emergency Line: 303-808-6895

Spruce Lake RV Resort Policies

ATVs: No ATVs or unlicensed motorized vehicles are allowed to operate within the park.

CABINS/COTTAGE: All cabins/cottages are non-smoking buildings. No pets are allowed in the cabins/cottages at any time. Cabins/cottages will be inspected at check-out time. Any damage to the cabins/cottages, or their contents, will be the renter's responsibility.

CHECK-IN TIMES: 1:00PM for RV sites. 3:00PM for cabins/cottages. Early check-ins are based on availability and will require an additional fee of \$25.00 prior to check in, no exceptions.

CHECK-OUT TIMES: 11:00AM for RV sites. 10:00AM for cabins/cottages. Late check-outs are based on availability and will require an additional \$25.00 fee. There are no refunds or credits for early departures. NO EXCEPTIONS.

CHILDREN: Parents or guardians are fully liable and responsible for the acts, conduct and safety of their children at all times. All unsupervised children under the age of 18 must be on their site by 10:00 PM.

CLOTHESLINES/HAMMOCKS: Are not allowed.

COMMON AREAS/FACILITIES: Our management is responsible for all common areas.

DOG PENS/FENCING: Not allowed.

FIRES: No open fires by the RV sites are allowed; only propane fire grills. Use of fires and charcoal grills is strictly governed by county, state and park management restrictions and bans.

FIREARMS/FIREWORKS: For the safety of all guests, the use of firearms or fireworks is prohibited.

LAUNDRY/RESTROOMS/SHOWERS: Help us to keep the restrooms and laundry facilities clean for your enjoyment. Please feel free to notify us if they are in need of attention.

RELEASE AND WAIVER OF LIABILITY:

To the extent permitted under Colorado law, the guest accepts camping privileges with the understanding that the guest and all members of the guest's party, do hereby waive, release, and agree to hold harmless Spruce Lake RV Resort (the "Resort") and its officers and employees from all liability for loss, damage, or injury to property or the person arising out of the use of the Resort's facilities. This waiver, release, and hold harmless agreement is intended to be as broad as permitted under Colorado law and apply to all uses of the Resort, including all portions of the individual camp sites and cabins, and all common areas within the Resort.

All facilities are used at your own risk. Our equipment, apparatuses and facilities are furnished solely for the convenience of our registered guests. A person using such does so at their own risk. The management will not be responsible for accidents, injuries or loss of property by fire, theft, wind, rain or act of God. Any damage and/or loss to site, other guests or facilities by any guest will be the responsibility of the guest. We do reserve the right to refuse service to anyone. Although we may escort you to your site as a courtesy, the ultimate responsibility for all property lies and remains with the driver of the vehicle. This also applies to ALL visitors.

MAIL/PACKAGE DELIVERIES: We do not accept any mail or package deliveries.

MARIJUANA: The possession and use of marijuana on this private property is prohibited.

PARKING: Parking is provided for one (1) vehicle at the site with your RV. Please DO NOT park in empty sites. All guests must park in designated areas. ALL vehicles MUST display the park-issued tag you receive at check-in at all times while in the park. This also applies to ALL visitors or you may be asked to leave. All guests must register at the office upon arrival. A \$5.00 resort fee per vehicle per person will be charged per day.

PET RULES:

- RV INN Properties are pet friendly.
- Dogs must be on leashes no longer than 6 feet at all times and attached to a person.
- Dogs may not be left unattended at any time.
- Excessive barking will not be tolerated and guests may be asked to leave.
- We provide "doggie bags" in our Pet Play Area. Please clean up after your dog.
- If it becomes necessary for park staff to clean up dog waste from your site, you will be charged \$25 for each location cleaned up.
- Any damage from your dog will result in charges equivalent to the incident, including replacement of any damaged items and labor.
- Any dog showing aggressive behavior or tendencies must leave the park immediately or will be reported to the local Animal Enforcement.
- If your dog is found in a cabin, you will be asked to leave immediately. No refunds will be issued and a \$250.00 cleaning fee will be charged to your credit card.
- No fencing, kennels or tethering allowed. No excessive barking or aggressive behavior allowed.
- The rule defines "service animal" as a dog that has been individually trained to do work or perform tasks for the benefit of an individual with a disability. The rule states that other animals, whether wild or domestic, do not qualify as service animals. Dogs that are not trained to perform tasks that mitigate the effects of a disability, including dogs that are used purely for emotional support, are not service animals.

POOL RULES:

- A. The pool is open from Memorial Day through Labor Day dependent upon weather. The pool will close in the event of lightning.
- B. The pool is for registered guests only.
- C. There is no lifeguard on duty; swim at your own risk.
- D. Diving is not allowed.
- E. The owners and management assume no responsibility for accidents or injury.
- F. Pool - Children under the age of 18 must be accompanied by an adult to enter the pool.
- G. Management reserves the right to restrict the use of the pool facility at any time.
- H. Violating any of these pool area rules will result in you being asked to depart immediately without refund.

PROPANE: Approved bottles will be filled only during regular office hours. 100 pound tanks are not allowed in the park. All propane tanks must be enclosed within the RV.

REPAIR: If you need repairs done to your rig, please check with the office for a list of local mobile repairmen. All vendors coming on resort property must have insurance on file.

***Making repairs to vehicles personally is not allowed.**

QUIET TIME: Quiet time is observed every night from 10:00PM to 8:00AM. We will not tolerate loud noises, fighting, abusive language, drunkenness, or disturbing others. Running of generators is not allowed.

REFUNDS/CREDITS: No refunds or camp credits are permitted. No exceptions.

RV REQUIREMENTS: All RVs must be owner occupied, well maintained and clean. Per Colorado law, each unit must have a 3 inch sewage sewer hookup. The sewer connection must be sealed to comply with Larimer County & State regulations. If you do not have one, they are available for purchase in our store.

RV SITES: We DO NOT guarantee specific sites. We reserve the right to assign campsites. No tents are allowed on an RV site. No mats are allowed on the grass.

SMOKING AND ALCOHOL: All buildings are non-smoking. Please dispose of butts in the proper receptacles. Colorado drinking age applies. No excessive drinking will be permitted.

SPEED LIMIT: 5 MPH and is strictly enforced. This applies to all driven vehicles.

SPRUCE LAKE FISHING: A Spruce Lake RV Resort permit is required. No fly rods allowed. No swimming, wading, rock and/or stone throwing allowed.

STORE: For your convenience, we offer a limited supply of gifts, RV supplies and groceries located at the office.

TENTS: Not allowed.

TRASH: We offer curbside pick-up every day. Please place all trash in tied plastic bags in front of your RV, near the road, between 8:00AM and 4:00PM. Do not leave garbage outside of these hours as we do have wildlife "visitors" in our area.

TRUCK CAMPERS/TOPPERS: Are not to be removed from the vehicle at any time.

VANDALISM: Anyone destroying property of Spruce Lake RV Resort will be prosecuted. Parents/Guardians are responsible for the safety and action of their children.

VISITORS: Guests are welcome but are required to check in and pay the applicable resort fee with the office prior to visiting your site; resort fee will be charged each day. You are responsible for your guests and any damage caused by them. Please share our Resort Policies with them. A guest failing to comply with the policies will lose visitor privileges and will be asked to leave. Visitors MUST display the vehicle tag they received at check-in at all times while in the park. Guests may be asked to leave if their visitor is not abiding by park policies.

WASHING VEHICLES: A permit is required. Please check with office first.

WINDS: Due to the unpredictable Colorado high winds, always secure awnings, roof vents and any loose objects. Any style canopy is not allowed.

NOTE: Anyone not following any of the above resort policies/rules will be asked to immediately leave the property without a refund.

ESTES PARK POLICE NON-EMERGENCY:
970-586-4000.

Facilities

Swimming Pool • Playground
Propane • Gift Shop • Horseshoes
Big Rigs & Groups Welcome

Spruce Lake RV Resort reserves the right to amend, revise and add to the RV Resort Policies at any time. No refunds or camp credits are permitted.
NO EXCEPTIONS.

THANK YOU for being our guest.
www.facebook.com/navspruce

This area guide was made possible by these businesses.
Please let them know you are staying at
Spruce Lake RV Resort.



Your Site # Is _____

Restroom/
Laundry Code _____



Seasonal Shuttle Stop

Mary's Lake Rd.

Green Area
Spruce Lake Dr.

Pet Play
Big Thompson River

Mini-Golf Course

Big Thompson River
Green Area (Pet Play)

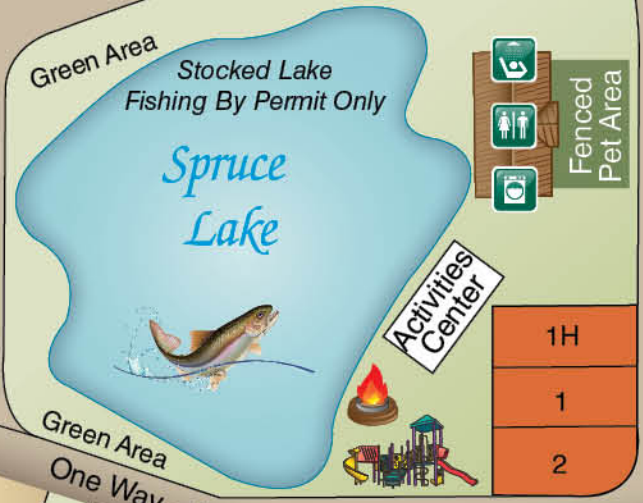
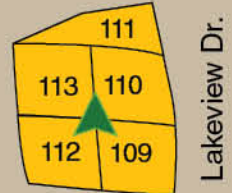
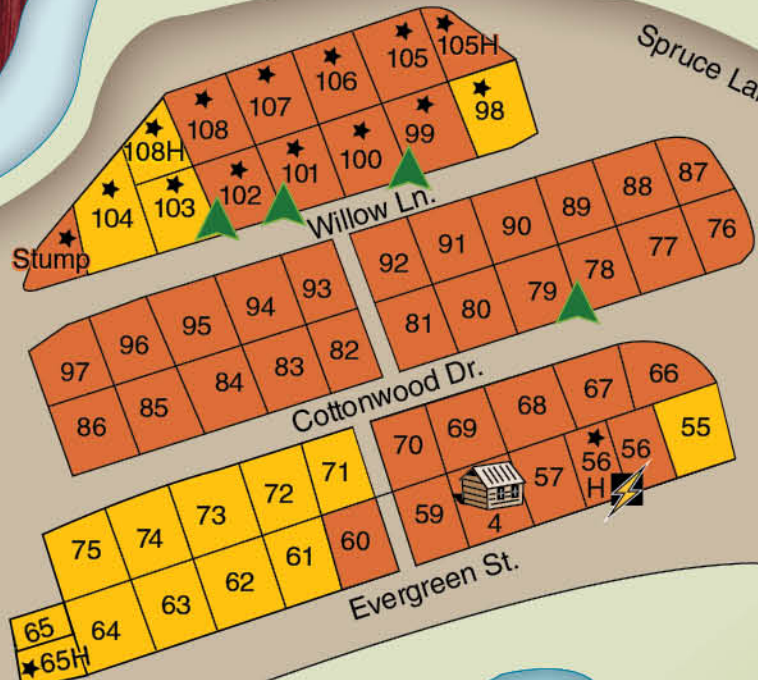

You Are Here

Office & Gift Shop/
General Store

Pool
Seasonal Memorial Day
thru Labor Day

One Way
Spruce Lake Dr.

Maintenance

Grandview
201
202
203
204
205
206



LEGEND

- Restrooms
- Laundry
- Showers
- Dump Station
- Fire Ring
- Cabin
- Playground
- Water & Electric
- Dry Camping
- 30 AMP
- 50/30 AMP
- Cottage
- Horseshoes
- Tree
- Electrical Box



All Rights Reserved © 2025



Estes Park

Rocky Mountain National Park
Mountain Time Zone

uhealth URGENT CARE - ESTES PARK

Shopping Center

uhealth ESTES VALLEY MEDICAL CENTER

SMOKIN' DAVE'S BBQ & BREW

THE BARREL

THE COUNTRY MARKET

FLAUGHER

Approx. 7 Miles

Printed in the USA

SMOKIN' DAVE'S BBQ & BREW

Open
Lunch & Dinner

GET SAUCED AT 7,522'!

smokindavesbbq.com

820 Moraine Ave.
Estes Park
No Reservations • No Call Aheads
970-577-7427

228 Main St • Lyons
303-823-7427

Ribs • Brisket
Pulled Pork
Southern Favorites
BBQ Chicken
Burgers • Salads
Homemade Desserts

THE BARREL

64 TAPS

CRAFT BEER

FULL BAR

WHISKEY

Locally Owned & Operated Support Local

THE COUNTRY MARKET

On Your Way to the Park

TheCountryMarketOfEstesPark.com

- Locally Owned Full Service Grocery Store & Deli
- Choice Meats
- Made to Order Sandwiches
- Hand-Dipped Ice Cream

900 Moraine Ave.

970-586-2702

Earn While You

EXPLORE WITH US

We Offer:

- 2-Week Free RV Stays
- Go Where You Want
- Commission and Additional Passive Income Opportunities

JOIN TODAY!

CONTACT:
ERIN@SEPub.COM
1-800-832-3292

URGENT CARE - ESTES PARK

- No appointment needed
- X-ray / splinting / casting
- Common illnesses / mild allergic reactions
- Altitude sickness

8 a.m. to 6 p.m. daily • 970.577.4500
420 Steamer Drive • Estes Park, CO

Estes Valley Medical Center is proud to be a part of UHealth.

uhealth

Join us TODAY!

The RV Bunch™

Find us on: **facebook.**

thervbunch.com



- ✓ Expert Guides
- ✓ Wildlife Viewing
- ✓ Off-Road Tours
- ✓ Timed Entry & Park Pass included with tour



Rocky Mountain National Park Tours

970.577.0034

157 Moraine Avenue
www.GreenJeepTour.com

RVING USA
REVIEW
★★★★★
The Parks You Visit on

RVINGUSA.COM



Saddle Up With
SK Horses

**\$10 off
2 Hours or
Longer with
this Ad**

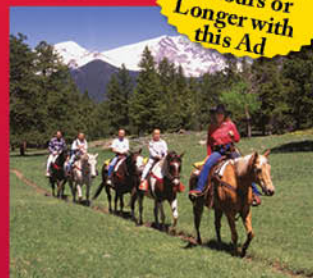

National Park

All rides into Rocky Mountain National Park

Gateway Stables

Hwy. 34 at RMNP Entrance

970-586-5269

www.SKHorses.com

Reservations Recommended

Operating 50+ Years!

ESTES VALLEY MEDICAL CENTER

- Full-service medical center and physician clinic
- 24/7 emergency department

970.586.2317
555 Prospect Avenue
Estes Park, CO

Estes Valley Medical Center is proud to be a part of UHealth.



Create memories...



... **GO**
CAMPING



Jeff Flaugher
Certified Technician

720-589-2338

FGRVS.COM

OUTDOOR GEAR
FLY FISHING

- Camping & Hiking Gear
- Guided Fishing Trips
- Binoculars



(Fly fishing Lessons, Rentals, Free Maps & Info)

ScotsSportingGoods.com

970-586-2877
870 Moraine Ave