

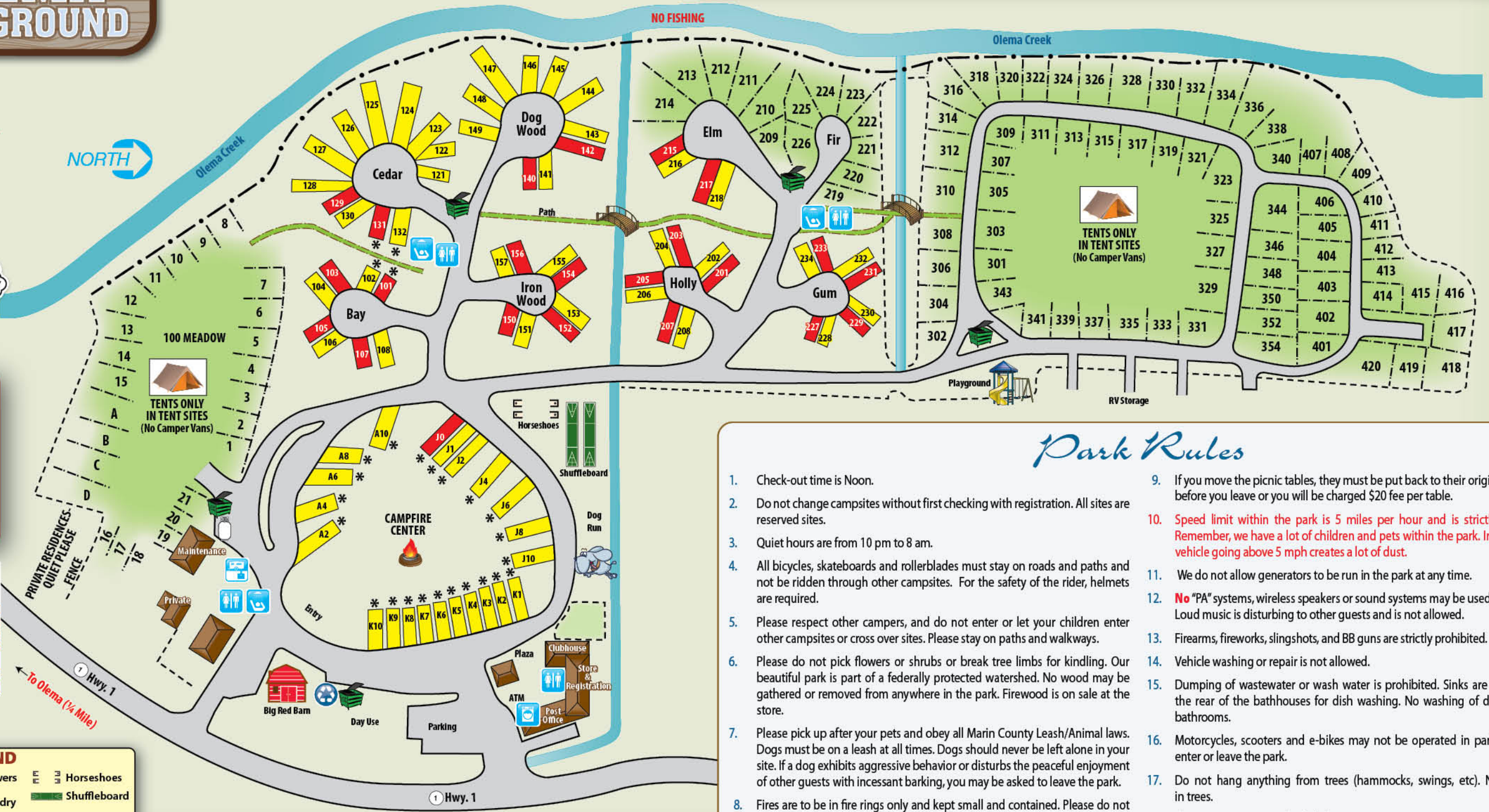

**OLEMA CAMPGROUND**  
 10155 Hwy. 1 • P.O. Box 145  
 Olema, CA 94950 • Marin County  
 415.663.8106 • 800.655.2267 (Toll Free)  
 www.OlemaCampground.net



**LEGEND**

Tent Sites	Showers	Horseshoes
Back-In RV Sites	Laundry	Shuffleboard
Pull-In RV Sites	Dump Station	Playground
Restrooms	Recycling	Campground Boundary
Sewer Hook-ups	Dumpster	
Propane		

Printed On Recycled Paper



## Park Rules

1. Check-out time is Noon.
2. Do not change campsites without first checking with registration. All sites are reserved sites.
3. Quiet hours are from 10 pm to 8 am.
4. All bicycles, skateboards and rollerblades must stay on roads and paths and not be ridden through other campsites. For the safety of the rider, helmets are required.
5. Please respect other campers, and do not enter or let your children enter other campsites or cross over sites. Please stay on paths and walkways.
6. Please do not pick flowers or shrubs or break tree limbs for kindling. Our beautiful park is part of a federally protected watershed. No wood may be gathered or removed from anywhere in the park. Firewood is on sale at the store.
7. Please pick up after your pets and obey all Marin County Leash/Animal laws. Dogs must be on a leash at all times. Dogs should never be left alone in your site. If a dog exhibits aggressive behavior or disturbs the peaceful enjoyment of other guests with incessant barking, you may be asked to leave the park.
8. Fires are to be in fire rings only and kept small and contained. Please do not move the fire rings. You will be charged a \$50 fine for non-compliance.
9. If you move the picnic tables, they must be put back to their original position before you leave or you will be charged \$20 fee per table.
10. **Speed limit within the park is 5 miles per hour and is strictly enforced. Remember, we have a lot of children and pets within the park. In addition, a vehicle going above 5 mph creates a lot of dust.**
11. We do not allow generators to be run in the park at any time.
12. **No "PA" systems, wireless speakers or sound systems may be used in the park. Loud music is disturbing to other guests and is not allowed.**
13. Firearms, fireworks, slingshots, and BB guns are strictly prohibited.
14. Vehicle washing or repair is not allowed.
15. Dumping of wastewater or wash water is prohibited. Sinks are available at the rear of the bathhouses for dish washing. No washing of dishes in the bathrooms.
16. Motorcycles, scooters and e-bikes may not be operated in park except to enter or leave the park.
17. Do not hang anything from trees (hammocks, swings, etc). No climbing in trees.
18. The most important rule of all, have a great time!!!!!!

**All children must be escorted by an adult after dark. We request that if you have children under 12, you keep them under close, adult supervision at all times. This includes in the store and laundry room. We ask that you please escort your small children to and from the play areas. The creek is not on our property. It contains old fence posts and wire, briars, fallen trees, other natural hazards, and Coho Salmon (which are on the endangered species list). Federal fines for injuring salmon are up to \$25,000 (per fish) and should be avoided.**

**Santa Rosa RV**  
 FAMILY OWNED & OPERATED SINCE 1992  
 707-569-7000  
 4241 SANTA ROSA AVE  
 SANTA ROSA, CA 95407

**GRAND DESIGN RECREATIONAL VEHICLES**  
**Rockwood** by Forest River  
**CHEROKEE W/LPUP**  
 2025 Models Starting from \$19,999!!

**NOW WE SERVICE ALL MAKES AND MODELS APPOINTMENTS AVAILABLE**

**WE BUY AND NO-FEE CONSIGNMENT**  
**santarosarvsales.com**

THERE'S MORE TO POINT REYES THAN YOU'D THINK. LISTEN TO KWMR RADIO TO FIND OUT.

**KWMR**  
 DOWNLOAD KWMR'S APP  
 OR TUNE INTO 90.5FM

**RVING USA** Mobile App  
 Find Places & Services Every RVer Needs

Download on the App Store  
 GET IT ON Google Play

**DUE WEST GOOD Food & Drink**  
 JUST A FIVE MINUTE WALK FROM OLEMA CAMPGROUND  
**TAVERN X MARKET**

10021 COASTAL HWY 1, OLEMA, CALIFORNIA 94950  
 OLEMAHOUSE.COM/DUE-WEST-RESTAURANT

Featured in National Geographic's World of Bread

**Brickmaiden Breads**  
 Naturally leavened breads, rustic pastries, and country lunch.  
 40 4th Street, Point Reyes Station  
 www.brickmaidenbreads.com

**RVING USA** Preferred Business  
 Look for the Seal  
 Support Businesses that Support Outdoor Recreation

**SKUNK TRAIN**  
 ride the world famous  
 TOUR THE REDWOODS  
 TAKE A RAILBIKE (ELECTRIC ASSISTED)  
 ENJOY A SECRET LOCAL'S BAR  
 FORT BRAGG AND WILLITS  
 SkunkTrain.com | 707.964.6371

**MARIN COUNTY**  
**Marshall**  
**Point Reyes Station**  
**Olema**  
**Fort Bragg**  
**San Geronimo**  
**Forest Knolls**  
**Bolinas**

**OLEMA CAMPGROUND**

Scenic Ave. Santa Rosa Ave. Exit 484 To Olema

Point Reyes Palomares Rd. Commodore Webster Dr. Bolinas Rd. Sir Francis Drake Blvd. N. HARBOUR DR. N. HARBOUR BRIDGE

ELM ST. SPRUCE ST. BUSH ST. PINE ST. LAUREL AVE. REDWOOD AVE. ALDER AVE. OAK ST. HAROLD ST. MAPLE ST. CHESTNUT ST. WALNUT ST. CYPRESS ST. SOUTH ST. RIVERTON

California Western Railroad - SKUNK TRAIN -

4 Miles

• Maps Not To Scale  
 All Rights Reserved ©

Southwest Publications • Doug / Warren • 12/25  
 Printed in the USA

EARN WHILE YOU EXPLORE WITH US

2-Week Free RV Stays  
**GO WHERE YOU WANT**  
 Commission and Additional Passive Income Opportunities

For Info: Erin@SEPUB.com  
 1-800-832-3292

**JOIN NOW**

**RVING USA** **REVIEW** ★★★★★  
 The Parks You Visit on  
**RVINGUSA.COM**

**RV SERVICE & REPAIRS**

**THE MOBILE RV MEDICS**

- Appliances
- Regular Maintenance & Service
- AC & Heating
- Electrical 12v DC & 120V AC
- Plumbing Repairs
- Roof Repairs
- Generator Repairs
- And Lots More

**707-970-9700**  
 We are here to help! Call us 24/7

**Thank You!**

When using the services of these advertising businesses, be sure to tell them you are staying at  
**Olema Campground.**

**Join us TODAY!**

**The RV Bunch**

Find us on: **facebook**

**thervbunch.com**